

# ANALYSER

# Mapper Customisation

February 2021



# OAG ANALYTICS

## Custom Maps in Mapbox

### Step 1

Click 'Custom' button under Map Style section in 'Customise Format' tab:

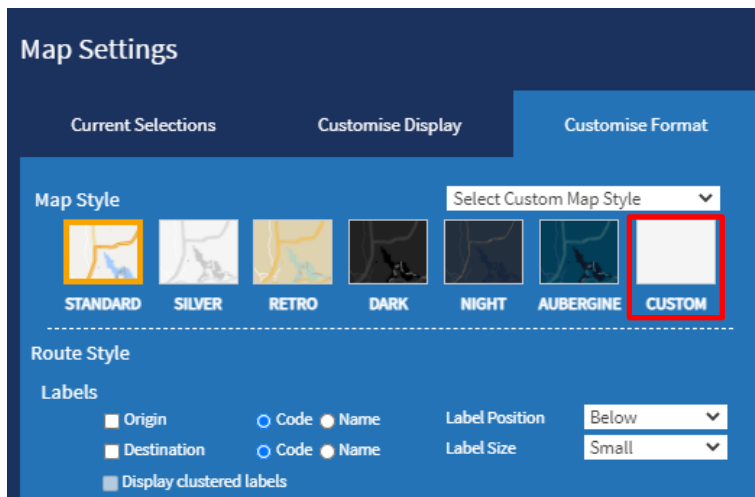

### Step 2

This pop-up box will appear:

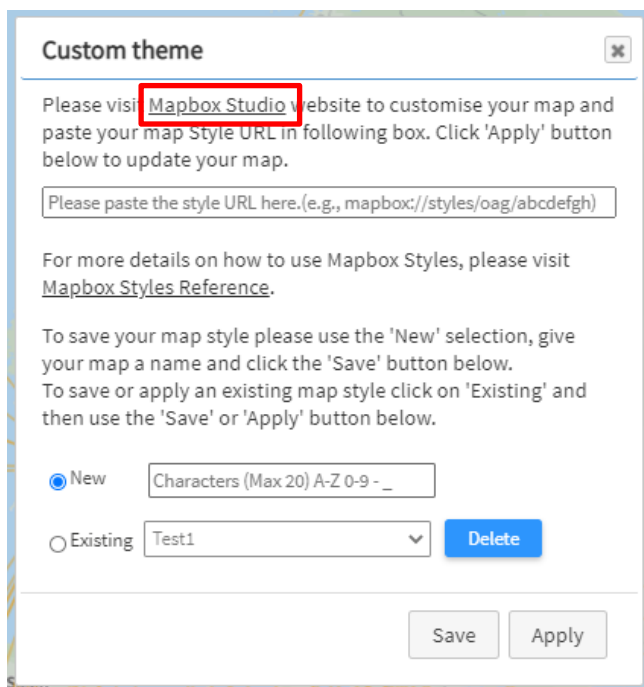

Click on 'Mapbox Studio' link and you will be taken to Mapbox.

# OAG ANALYTICS

## Step 3

When you click this link for the 1<sup>st</sup> time you will need to set up a Mapbox account, this is really easy and you only need to fill out the following:

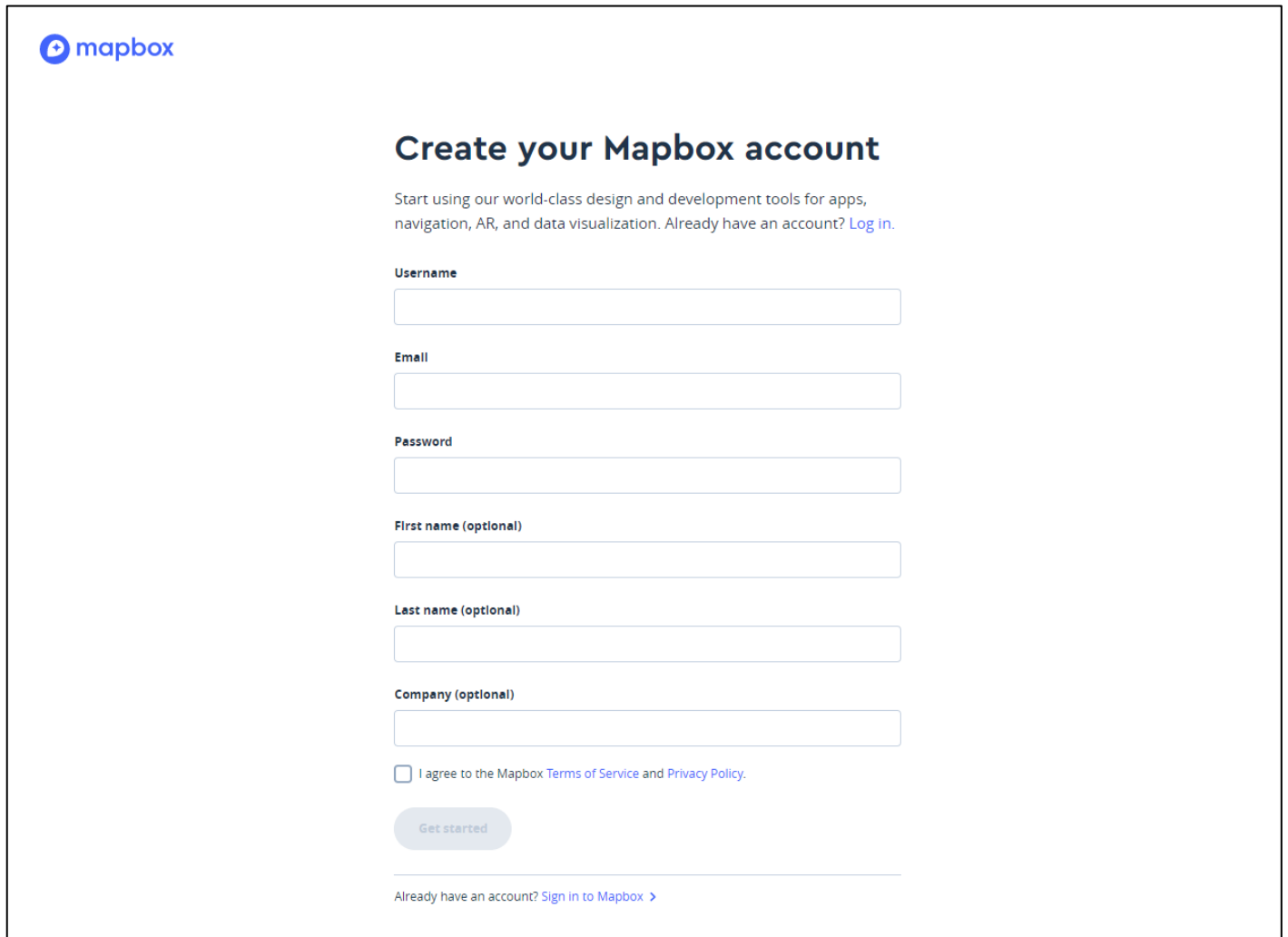

The screenshot shows the Mapbox account creation page. At the top left is the Mapbox logo. The main heading is "Create your Mapbox account". Below this is a subtext: "Start using our world-class design and development tools for apps, navigation, AR, and data visualization. Already have an account? [Log in.](#)". The form consists of several input fields: "Username", "Email", "Password", "First name (optional)", "Last name (optional)", and "Company (optional)". Below these fields is a checkbox labeled "I agree to the Mapbox [Terms of Service](#) and [Privacy Policy](#)". At the bottom of the form is a "Get started" button. Below the button, there is a link: "Already have an account? [Sign in to Mapbox >](#)".

Once you have created your account and you click 'Mapbox Studio' link in Mapper you will go straight to your map **Styles**, it will look like this:

# OAG ANALYTICS

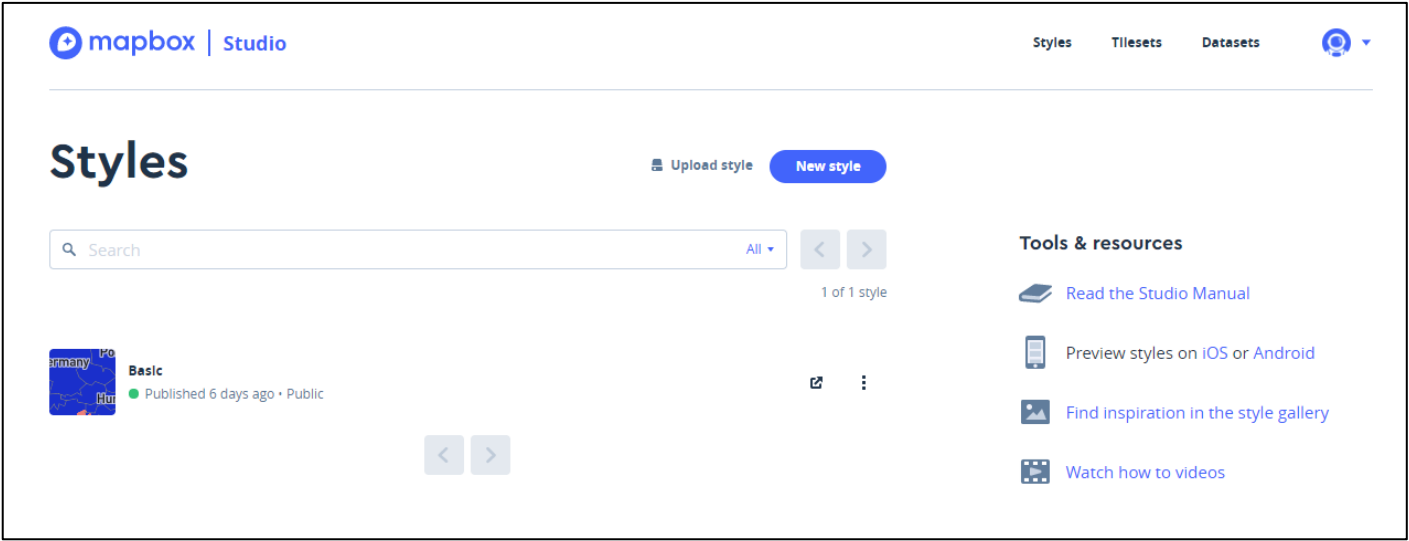

## Step 4

To create a new map click ‘New Style’ or you can edit an existing style, these are shown in a list below the search bar.

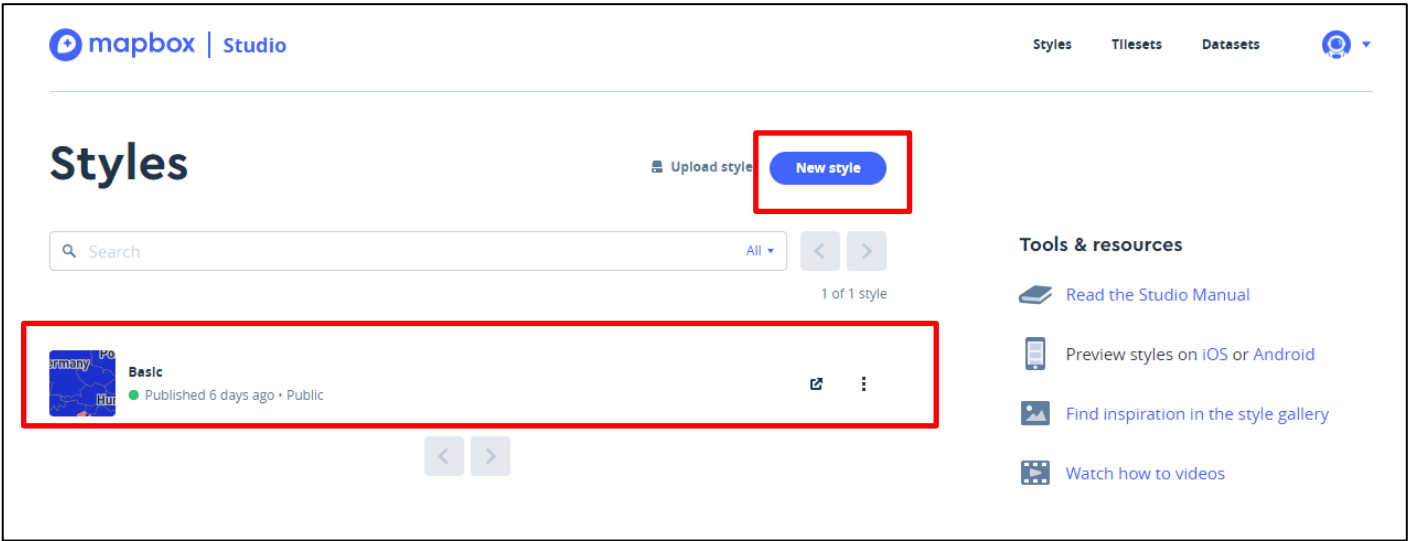

# OAG ANALYTICS

## Step 5

This map has been created as an example in Mapbox and we will use this as we go through the steps:

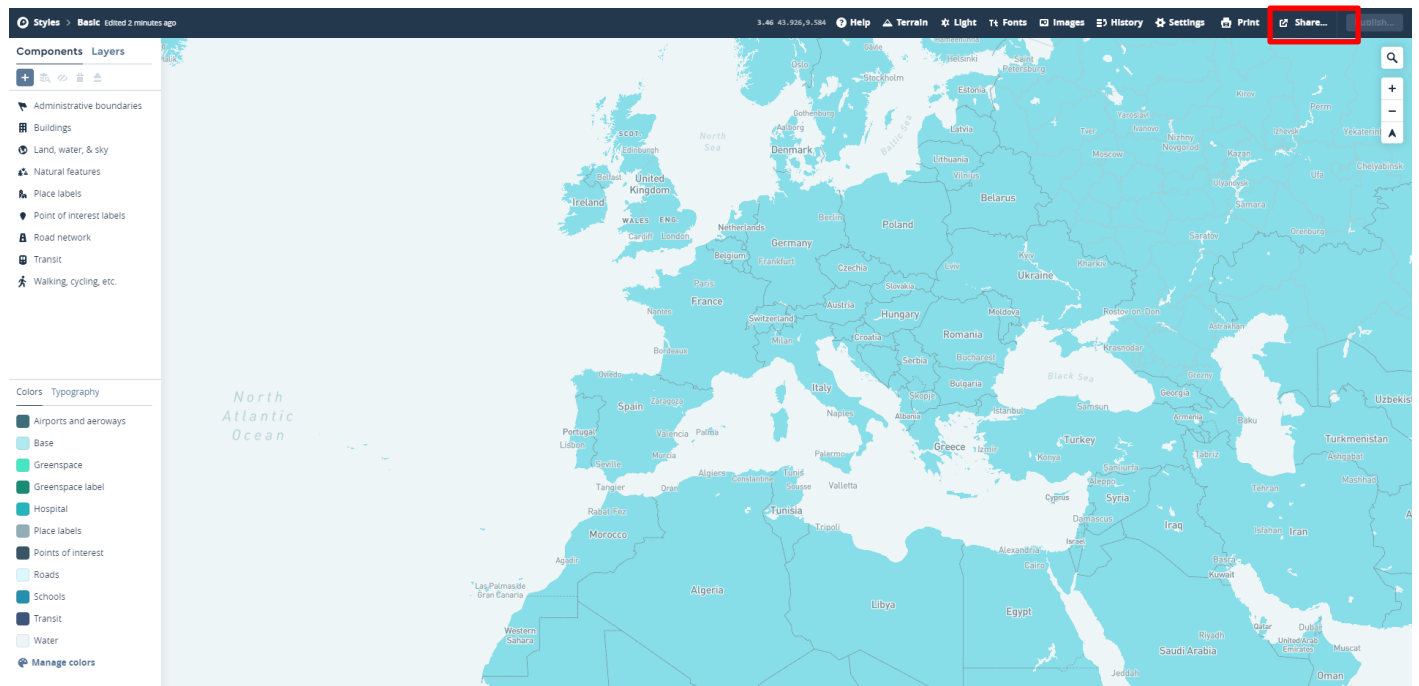

Once you have created your map, click 'Share' in the top right hand corner. Once you have clicked 'Share', a pop-up box will appear.

# OAG ANALYTICS

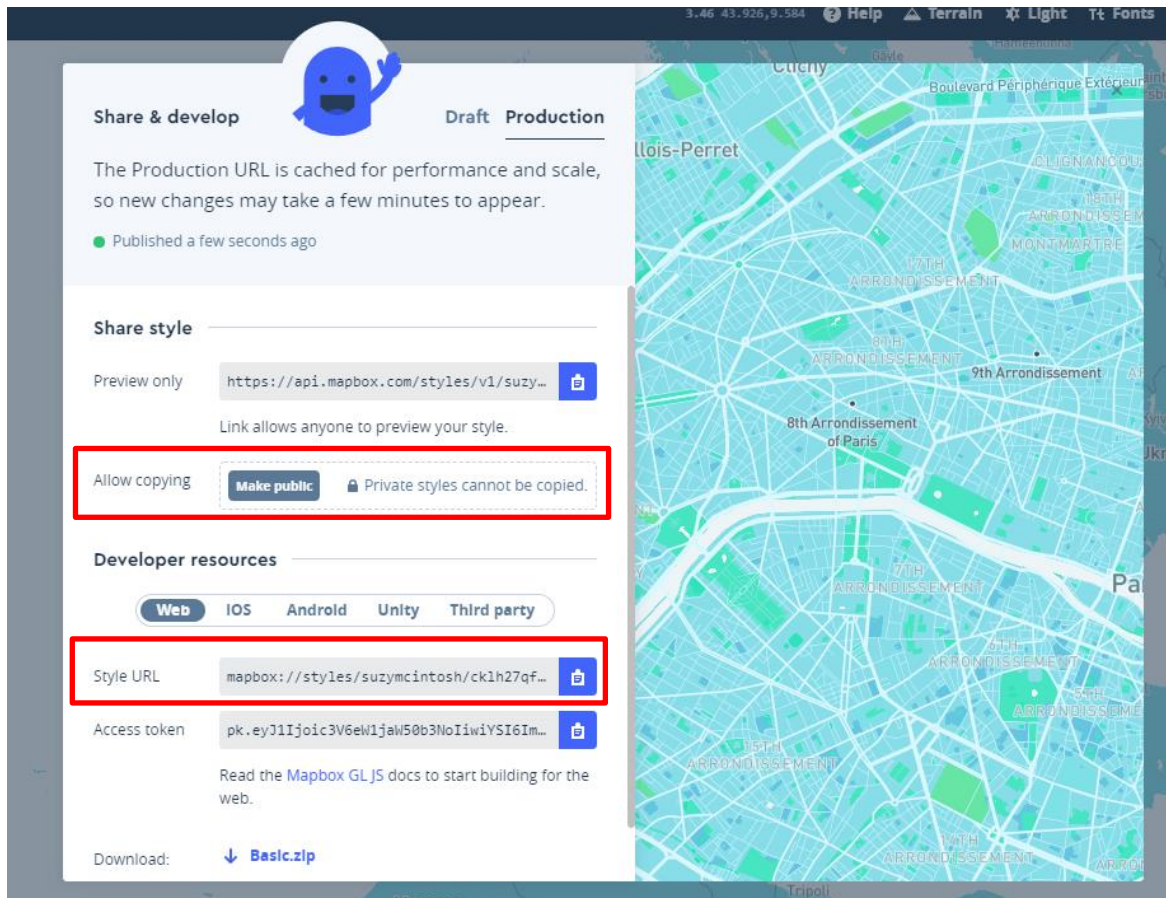

There are 2 steps to carry out in this pop-up box:

1. Click in the section Allow copying '**Make Public**'.
2. Under Developer resources, Style URL, click the **blue button** at the end of the string to copy your Style URL. In this example our Style URL is:  
mapbox://styles/suzymcintosh/cklh27qf6064617ozsx4b08gu.

## Step 6

**Paste** Style URL into Mapper pop up box:

# OAG ANALYTICS

Custom theme

Please visit [Mapbox Studio](#) website to customise your map and paste your map Style URL in following box. Click 'Apply' button below to update your map.

mapbox://styles/suzymcintosh/cklh27qf6064617ozsx4b08gu

For more details on how to use Mapbox Styles, please visit [Mapbox Styles Reference](#).

To save your map style please use the 'New' selection, give your map a name and click the 'Save' button below.  
To save or apply an existing map style click on 'Existing' and then use the 'Save' or 'Apply' button below.

☒ New

Characters (Max 20) A-Z 0-9 - \_

☐ Existing

Test1

▼

Delete

Save

Apply

Click '**Apply**' in the bottom of the pop-up box in Mapper.

The map is now updated in Mapper with the new style:

# OAG ANALYTICS

## Changing an Existing Map Style

Once you have a map style created in Mapbox you can change the colours of the map and this will automatically update in Mapper.

### Example

Using our example above we want to change the colour of the land to a darker blue. We go to Mapbox Styles in Mapbox Studio and click the map we want to change. We update the map, in our example we will make the land a darker blue. Once these changes have been made in Mapbox, click **'Publish'** in top right-hand corner:

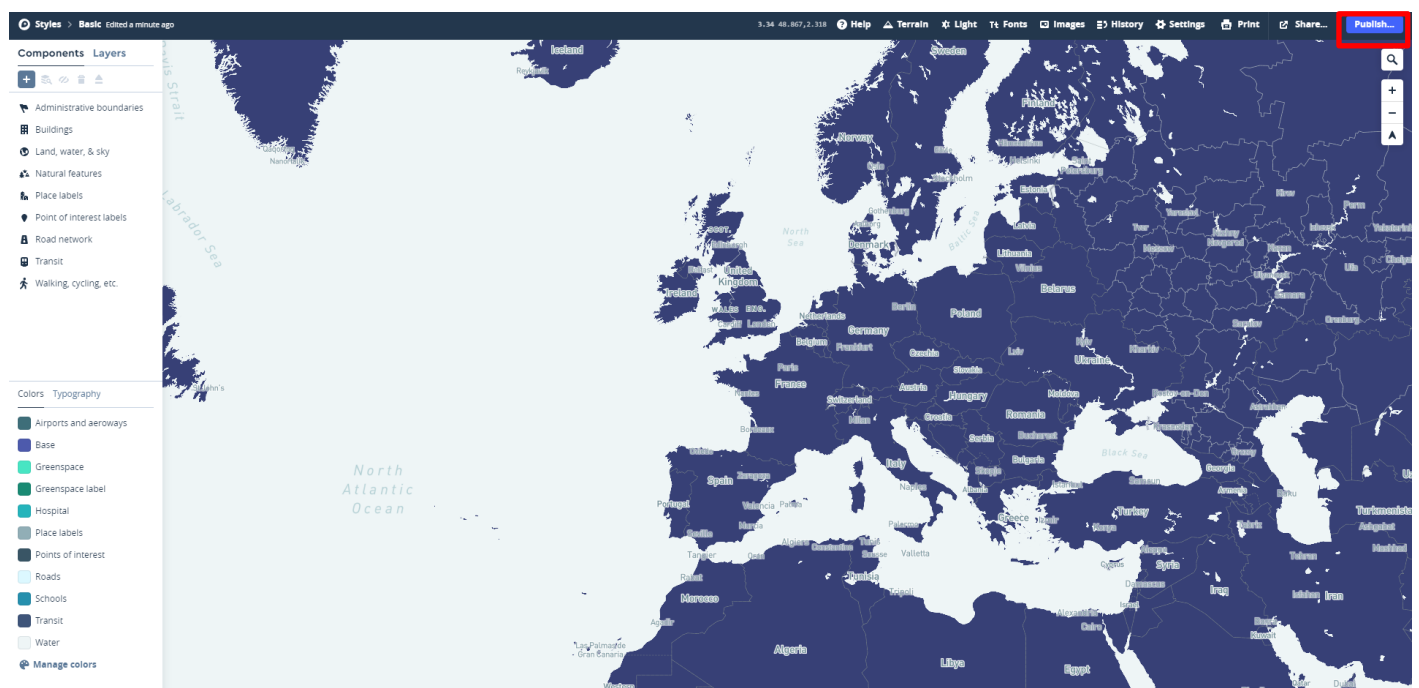

A pop up box will show, click **'Publish'**:

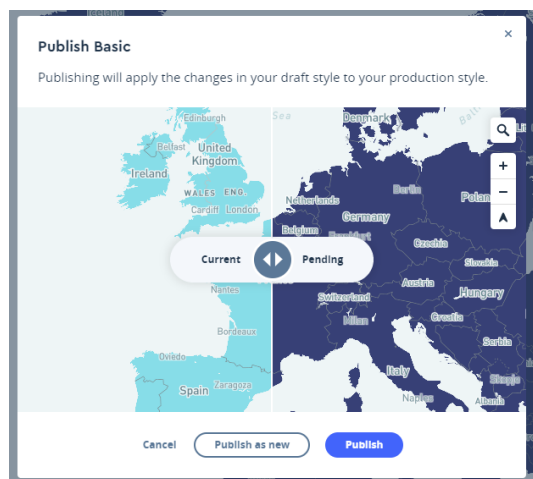

# OAG ANALYTICS

This will be updated in Mapper. It takes 5 minutes for the change to go through to Mapper.

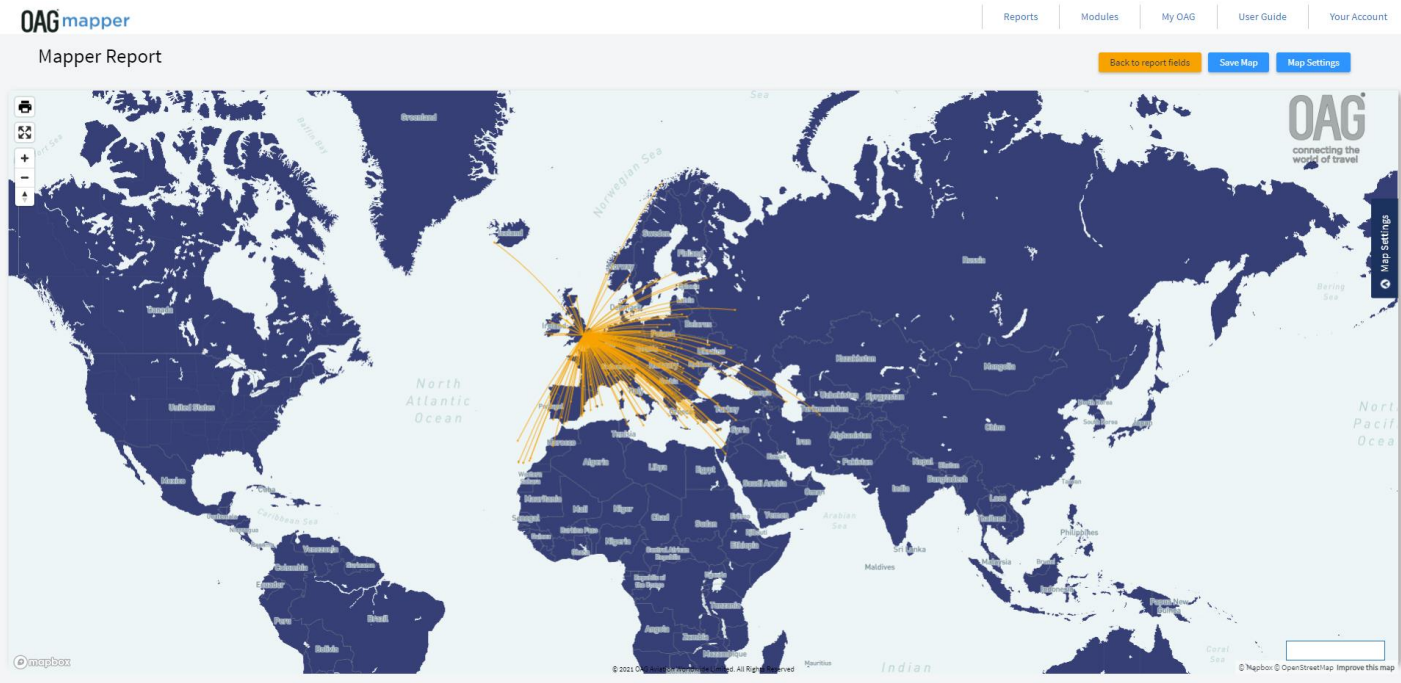

This is our new map with our land dark blue.